

Serving Industry
for
2 Decades



Since 1987

KASTHURI MACHINE BUILDERS

Manufacturers:

Self Feed Drilling Machines

Tapping Machines

Multi Spindle

Fixed Multi Spindle

Drill Heads

Deep Hole Drilling Machine



Components we handled

KMB -12-125 SELF FEED DRILLING MACHINE-PNEUMATIC

MAX. DRILLING CAPACITY - Ø10 in STEEL

MOTOR POWER	0.75KW/1440 RPM	0.75KW/2880 RPM
SPINDLE SPEED	940,1440,2200 RPM	1880,2880,4400 RPM
SPINDLE TRAVEL	125mm	
WORKING STROKE	30mm(Variable)	
WORKING AREA	225mmX225mm	
THRUST LOAD AT 6 bar	127KG	
DISTANCE BETWEEN SPINDLE TO TABLE MAX	310mm	
DISTANCE BETWEEN SPINDLE CENTER TO COLUMN FRONT	185mm	
DISTANCE FROM TABLE TOP TO BASE	715mm	
AIR PRESSURE REQUIRED	5-6 bar	
MACHINE SIZE(mm)	720L x 500W x 1700H	

SPINDLE NOSE

DIN55058

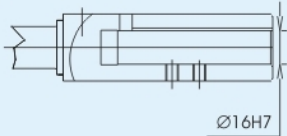

RD25 COLLET

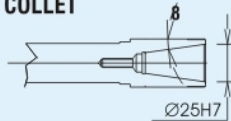

*Specifications may change due to continuous product development



KMB-12-125 SELF FEED DRILLING MACHINE-HYDRAULIC

MAX. DRILLING CAPACITY - Ø 12 in STEEL

MOTOR POWER	0.75KW/1440RPM	0.75KW/2880RPM
SPINDLE SPEED	940,1440,2200RPM	1880,2880,4400RPM
SPINDLE TRAVEL	125mm	
WORKING STROKE	100mm(Variable)	
WORKING AREA	225mmX225mm	
THRUST LOAD AT 10 bar	210Kg	
DISTANCE BETWEEN SPINDLE TO TABLE MAX.	310mm	
DISTANCE BETWEEN SPINDLE CENTER TO COLUMN FRONT	185mm	
DISTANCE FROM TABLE TOP TO BASE	715mm	
HYDRAULIC POWER PACK		
MOTOR POWER	0.75KW/1440 RPM	
TANK CAPACITY	75Lts	
PUMP OUTPUT	15.6 lpm	
OPERATING PRESSURE	30-35 bar	
MACHINE SIZE(mm)	1200L x 500W x 1700H	

SPINDLE NOSE

DIN55058

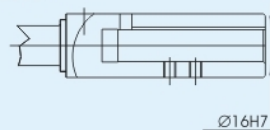

RD25 COLLET

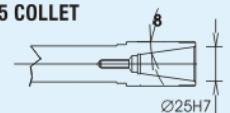

*Specifications may change due to continuous product development

KMB -20-100 SELF FEED DRILLING MACHINE-PNEUMATIC

MAX. DRILLING CAPACITY - 18 in STEEL

MOTOR POWER (RPM)	1.1KW/1000	1.1KW/1440	1.1KW/2880
SPINDLE SPEED (RPM)	510,1000,1830	750,1440,2600	1500,2880
SPINDLE TRAVEL	100mm		
WORKING STROKE	70mm(Variable)		
WORKING AREA	350mmX340mm		
THRUST LOAD AT 6bar	395Kg		
DISTANCE BETWEEN SPINDLE TO TABLE MAX	450mm		
DISTANCE BETWEEN SPINDLE CENTER TO COLUMN FRONT	213mm		
DISTANCE FROM TABLE TOP TO BASE	750mm		
AIR PRESSURE REQUIRED	5-6 bar		
MACHINE SIZE(mm)	810L x 700W x 1900H		

SPINDLE NOSE

DIN55058

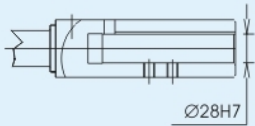

MT3

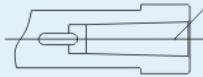

MT3

*Specifications may change due to continuous product development



KMB -20-100 SELF FEED DRILLING MACHINE-HYDRAULIC

MAX. DRILLING CAPACITY - 20 in STEEL

MOTOR POWER (RPM)	1.1KW/1000	1.1KW/1440	1.1KW/2880
SPINDLE SPEED (RPM)	510,1000,1830	750,1440,2600	1500,2880
SPINDLE TRAVEL	100mm		
WORKING STROKE	80mm(Variable)		
WORKING AREA	350 X 340mm		
THRUST LOAD AT 10bar	660Kg		
DISTANCE BETWEEN SPINDLE TO TABLE MAX.	450mm		
DISTANCE BETWEEN SPINDLE CENTER TO COLUMN FRONT	213mm		
DISTANCE FROM TABLE TOP TO BASE	750mm		
HYDRAULIC POWER PACK			
MOTOR POWER/RPM	0.75KW/1440		
TANK CAPACITY	75Lts		
PUMP OUTPUT	15.6 lpm		
OPERATING PRESSURE	30-35 bar		
MACHINE SIZE(mm)	1300L x 700W x 1900H		

SPINDLE NOSE

DIN55058

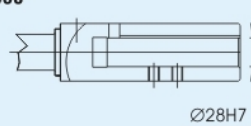

MT3

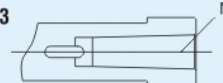

MT3

*Specifications may change due to continuous product development

KMB - 8 / KMB - 16 LEADSCREW AUTOMATIC TAPPING MACHINE



	KAMB - 8	KAMB - 16
MOTOR POWER (RPM)	0.55KW/1000	1.1KW/750
SPINDLE SPEED (RPM)	SINGLE SPEED (According to Tap size)	SINGLE SPEED (According to Tap size)
PITCH CONTROL	BY LEAD SCREW&NUT	BY LEAD SCREW&NUT
SPINDLE TRAVEL	80mm	60mm
MAX. TAPPING CAPACITY	M 8 IN STEEL	M 16 IN STEEL
WORKING AREA	225 X 225mm	350 X 340mm
DISTANCE BETWEEN SPINDLE TO TABLE MAX.	310mm	450mm
DISTANCE BETWEEN SPINDLE CENTER TO COLUMN FRONT	185mm	213mm
DISTANCE FROM TABLE TOP TO BASE	715mm	750mm
MACHINE SIZE(mm)	720L x 500W x 1700H	810L x 700W x 1900H

SPINDLE NOSE

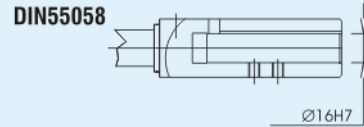

*Specifications may change due to continuous product development



HIGH SPEED DEEP HOLE DRILLING MACHINE

MAX. DRILLING CAPACITY	4mm
HEAD STROKE LENGHT	200mm
MOTOR POWER	0.75KW/3000 RPM
Max. SPINDLE SPEED (RPM)	12,000
HEAD MOVEMENT	LM GUIDE WITH BALL SCREW
DEPTH CONTROL	BY LEAD SCREW&NUT
BALL SCREW DRIVE	SERVO MOTOR
FEED	INFINITELY VARIABLE
SWING OVER BED	136mm
DISTANCE BETWEEN SPINDLE CENTER TO BASE	100mm
MACHINE SIZE(MM)	800L x 530W x 1300H

*Specifications may change due to continuous product development

DEALER



Since 1987

KASTHURI MACHINE BUILDERS

4-H, G.N.Mills Post, Gandhinagar, Coimbatore -641 029. Tel : +91 422 2643338 Fax : +91 422 2644623
email: kmb@sancharnet.in, kmbcbe@vsnl.net Website: www.kasthurimachines.com